



Municipality of Anchorage

Anchorage Water & Wastewater Utility



Engineering Division

<http://www.awwu.biz>

3000 Arctic Boulevard • Anchorage, Alaska 99503-3898 • Fax (907) 562-0824

Mayor Mark Begich

January 16, 2007

**RE: Douglas Drive Sewer Upgrade
AWWU Project 0000003575**

Dear Property Owner or Resident,

The Douglas Drive Sewer Upgrade project is part of the Anchorage Water and Wastewater Utility (AWWU) Capital Improvements Program. This project extends from Turnagain Parkway to just north of Redoubt Court (see attached map). The wood stave sanitary sewer main that serves this portion of Douglas Drive was constructed in 1953. Due to the age and condition of this pipe, AWWU has had to routinely clean this sewer main in order to maintain sanitary sewer service to customers along Douglas Drive.

AWWU is currently completing the design phase of this project. The construction of the project is currently anticipated to begin in early June, 2007 and will be completed within 60 days of beginning construction. The project will be constructed in three segments (see attached map). Segments one and three consist of using trenchless technology (Cured in Place Polyethylene Pipe) to re-habilitate the sewer main with little or no excavation. Segment two consists of excavating and replacing the sewer main, manholes, and service connections to property line in the area shown on the attached map. The project construction will begin with segment two. Segments one and three will be constructed after completion of segment two. Throughout the project, intermittent road closures with detours for Douglas Drive and Turnagain Blvd. will be required. Local access to residences will be provided during these closures.

You are welcome to join us at the next Turnagain Community Council meeting on February 1, 2007 at 7:00 pm at Turnagain Elementary School. We will be presenting the project and answering any questions concerning it. Please call me at 564-2763 if you have any questions or comments.

Respectfully,

Stephen Nuss, P.E.
Project Engineer

Community, Security, Prosperity

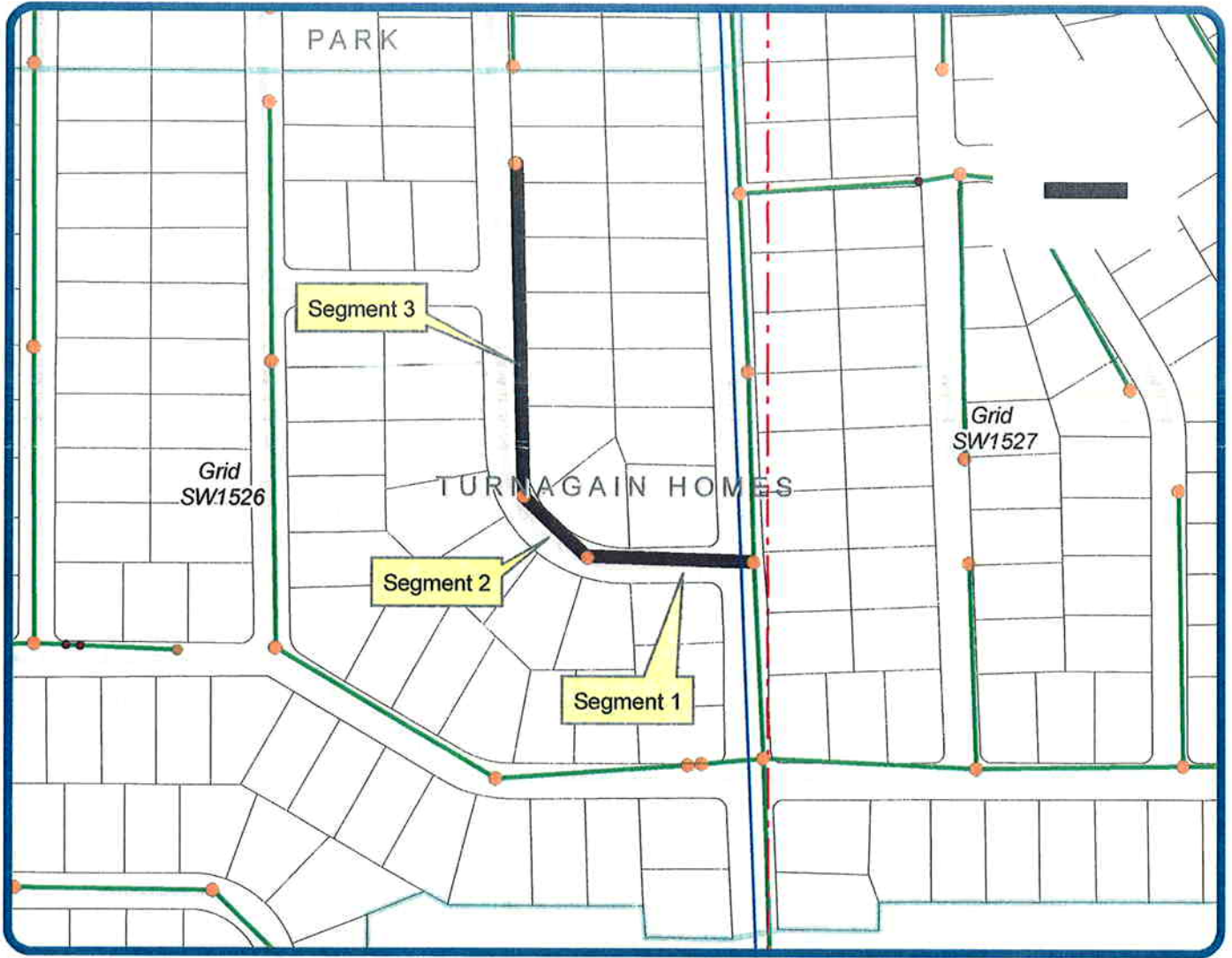





PROJECT MAP GRID SW1526

Map N.T.S.

Map Created
1/16/07 BKL
PM ID 3068



Legend

-  Proposed Sewer Upgrades
-  Existing Sewer Lines
-  Approximate Location
-  (unlabeled)

Douglas Street Sewer Upgrade

PeopleSoft Project ID # 0000003575

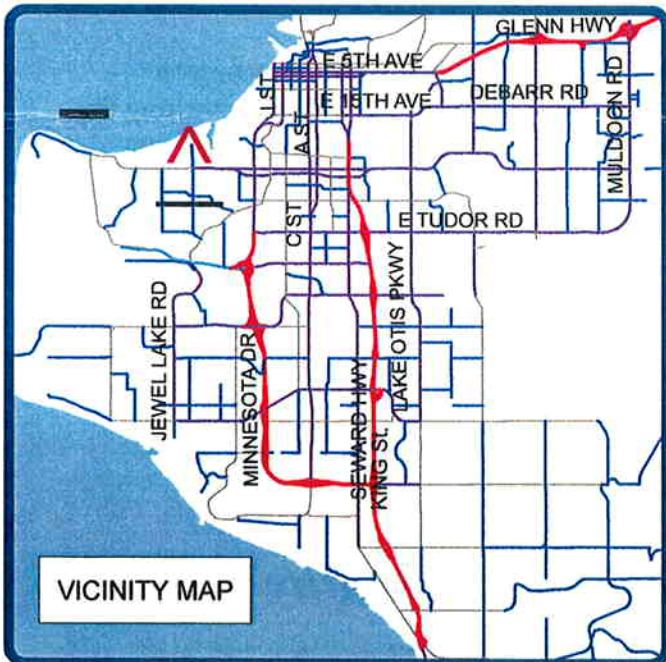

VICINITY MAP

Anchorage Water & Wastewater Utility